

FORESTAY DETAILS  
DEFINITION ETAI

FURLING SYSTEM INSTALLATION  
MONTAGE ENROULEUR

KIT DETAILS  
DETAILS KIT

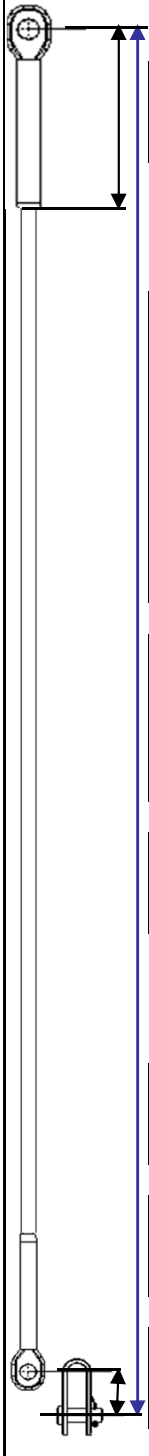

Top terminal  
**Terminaison**  
108 mm

Head mast pin-  
to-deck pin  
forestay length  
axe cad mât-à  
-axe cad pont  
Longueur étai  
axe à axe  
11454 mm

Forestay Ø  
Ø étai  
6 mm

Type  
CABLE

Manufacturer  
Fabricant  
MARINE TECH

Bottom pin Ø  
Ø axe bas  
12,7 mm

Toggle width  
Largeur chape  
38 mm

Height toggle  
Hauteur chape  
48 mm  
chape pour D8mm

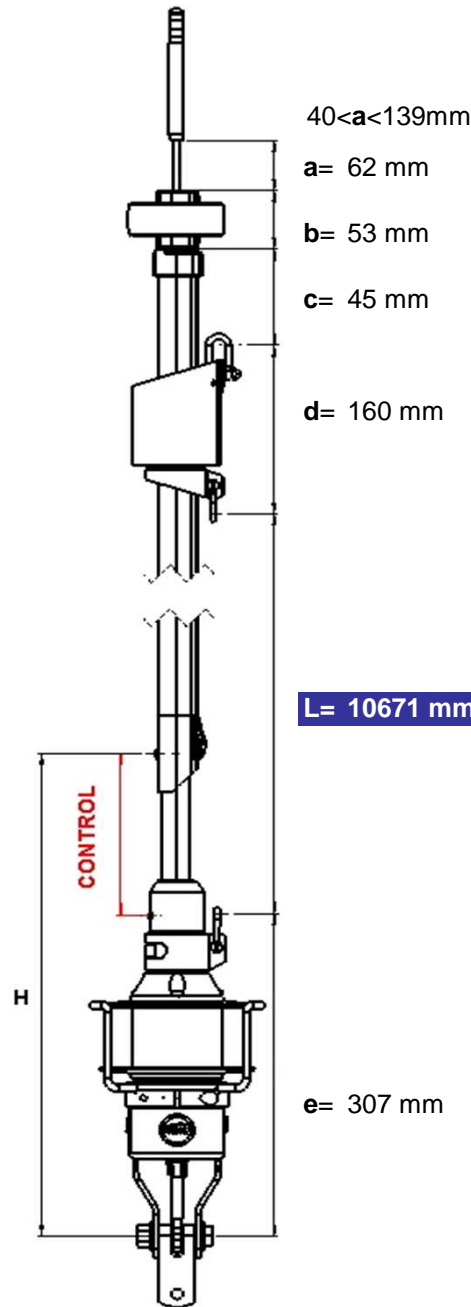

40<a<139mm

a= 62 mm

b= 53 mm

c= 45 mm

d= 160 mm

L= 10671 mm

e= 307 mm

H= 684 mm

CONTROL= 382 mm

Part nber/Code Facnor: BEN20673800  
OEM part n/code chant.: 206738

FOIL SECTION KIT DETAILS

1 top foil section of / tube haut de 1450 mm  
4 x 2 m  
1 x 1 m  
1 inner section / tube interne 1465mm  
5 connectors / manchons  
weight parcel/poids colis 12 kg

Foil section and connector dimensions

Dimension profil et manchon

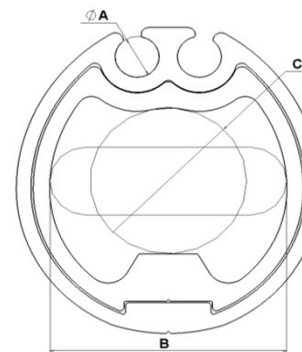

SX33

A=Luff tape Ø

Ø rallingue finie  
ØA= 5 mm

B=max inner width  
larg interne max  
B= 26 mm

C=connector inner Ø  
Ø interne manchon  
ØC= 16 mm

BOX DETAILS

Part nber/Code Facnor: BEN20673000  
OEM part n/code chant.: 206730

1 drum/tambour STANDARD LS100  
0 internal turnbuckle fitting/option avale rid.  
1 pin / axe Ø 12,7 mm  
1 link plates of/lattes de 100 mm  
toggle width/larg chape 36 mm  
10 bushing/paliers  
1 swivel/curseur  
1 halyard deflector wheel/RDD PM  
24 screws/vis

1 sail feeder/entrée de voile STD  
1 furling line/cordage D8mmx24M  
white-blue thread/blanc-filet bleu  
0 stanchion blocks/poulies chandelier  
0 lead fittings/filoirs  
part nber/code 24108240000  
weight parcel/poids colis 5,6 kg

MODIFICATIONS DETAILS

Date	By	Details (reasons and actions / raisons et actions)	from order nber/à partir cde n°